

DATA SHEET

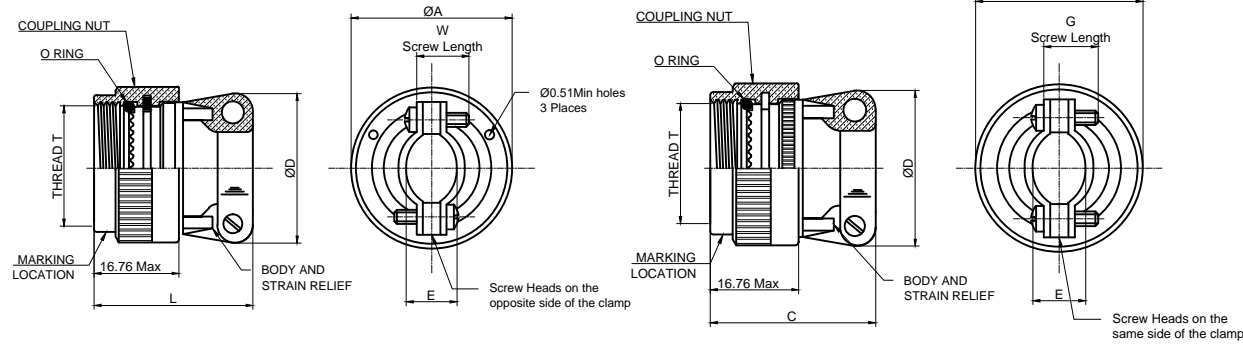

Figure-1: DIMENSION AND CONFIGURATION (NON SELF LOCKING) Figure-2: DIMENSION AND CONFIGURATION (SELF LOCKING)

ORDERING INFORMATION

	M85049 / 38 S 11 W
BASIC PART NUMBER	_____
SPECIFICATION SHEET	_____
CONFIGURATIONS - S : Self Locking - : Non Self Locking	_____
SHELL SIZE - Refer Table 1.	_____
FINISH - W : Cadmium Olive Drab N : Electroless Nickel A : Black Anodized	_____

Table-1: SHELL SIZES & DIMENSIONS

SHELL SIZE	SHELL CODE	NON SELF LOCKING		SELF LOCKING		NON SELF LOCKING & SELF LOCKING					
		ØA	L	ØF	C	E	ØD	THREAD T	G	SCREW	
		MAX	MAX	MAX	MAX	MIN	MAX	MAX	6H	-1.57	SIZE
09	A	19.10	27.90	21.79	30.70	2.49	5.94	21.60	M12 X 1.0	12.70	6-32
11	B	21.60	27.90	24.99	30.70	3.89	5.94	22.90	M15 X 1.0	12.70	6-32
13	C	25.40	30.50	29.39	33.30	4.83	8.33	27.90	M18 X 1.0	15.88	6-32
15	D	27.90	31.80	32.49	34.30	6.60	11.61	29.20	M22 X 1.0	19.05	6-32
17	E	31.80	34.30	35.71	36.80	7.19	15.60	33.00	M25 X 1.0	19.05	6-32
19	F	35.60	40.60	38.51	43.40	8.26	16.10	38.10	M28 X 1.0	19.05	8-32
21	G	38.10	43.20	41.71	46.00	8.71	17.73	40.60	M31 X 1.0	22.23	8-32
23	H	41.90	47.00	44.91	49.50	9.68	20.90	43.20	M34 X 1.0	25.40	8-32
25	J	44.50	49.50	47.98	52.10	10.62	21.67	45.70	M37 X 1.0	28.58	8-32

Table-2: MATERIAL AND FINISH

SPECIFICATION		
COMPONENT	MATERIAL	FINISH
Shell	Aluminium	Cadmium Olive Drab
		Electroless Nickel
		Black Anodized
Fastners	Stainless Steel	Passivated

Note:-

1. All Dimensions are in mm
2. Coupling nut shall be captivated and rotatable.
3. Clamps shall not have any sharp edges.
4. Wire Bundle accommodation range is defined as the envelope area of the wire bundle

1	Rev - 00	Change Date	Changes	Changed by:-	Checked by :-	Approved by:-	1
Title CONNECTOR ACCESSORIES STRAIN RELIEF; SELF LOCKING AND NON SELF LOCKING, MIL-DTL-38999 SERIES III & IV				Part Number M85049/38			SHEET 1 OF 1.
Drawn by :-		All dimensions are in mm.					
Checked by :-		Linear Tolerance: ±0.20 mm.					
Approved by :-		Angular Tolerance: ± 2°					
Approved date :-		03/05/2021					