

IF IN DOUBT ASK CLARIFICATION,  
DO NOT SCALE.

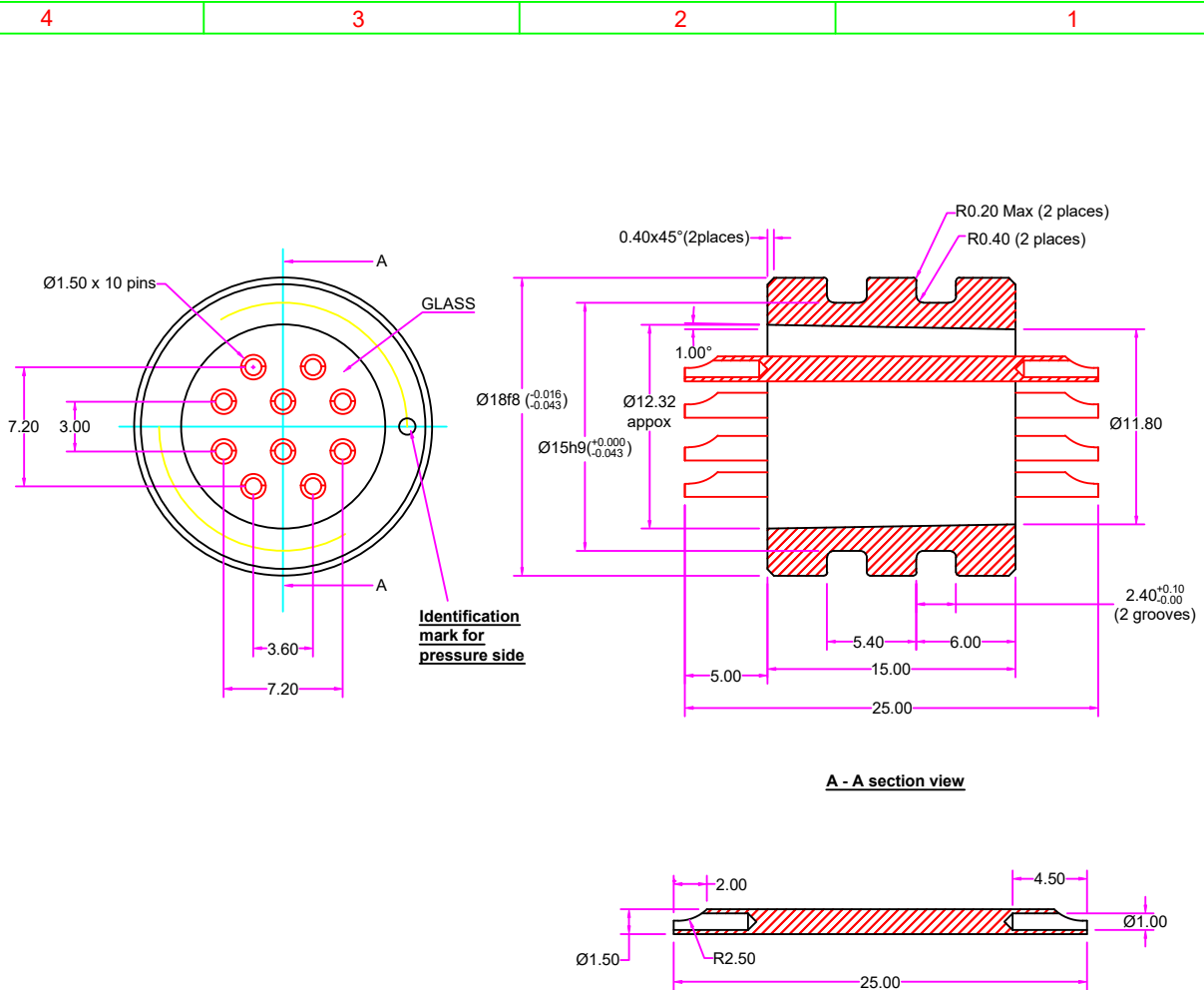

**TECHNICAL DETAILS:**

1. SHELL MATERIAL & FINISH : SS316L & NICKEL PLATING.
2. CONTACT PIN MATERIAL & FINISH : INCONEL X750 & NICKEL PLATING.
3. SEALING : GLASS TO METAL HERMETIC.
4. SURFACE ELECTROPOLISH.
5. TEMPERATURE RANGE: -55 ~ 200°C.
6. PRESSURE RATING: 120 MPa.
7. MAX CURRENT ON PINS 12AMPS.
8. LEAK RATE: 1\*10<sup>-9</sup> cc/sec @ 1atm pressure Differential (Helium).
9. INSULATION RESISTANCE: 1000M OHMS @500V DC AT AMBIENT.
10. NOTE THE PRESSURE SIDE INDICATED BY IDENTIFICATION MARK.
11. "O" RING DIMENSION OD-Ø18, ID-Ø14.6(-0.3) & THICKNESS-1.9 (±0.1)mm (2 no's "O" ring per connector). BODY & PIN DRG NO :TC 1579U

NOTE: ALL DIMENSION ARE IN mm.

COMPONENTS SHALL BE FREE OF BURRS ON ALL EDGES & CORNERS.

AS PER IS:2102-1993			HOLES		TITLE.	<b>10 PIN CONNECTOR GTMS ASSEMBLY</b>				
LINEAR	ANGULAR	IS : GRADE	CLEAR H12	THREADED CLASS 6H UNPLATED/ UNCOATED.	MATERIAL.	<b>BODY (SS 316L) &amp; CONTACT PIN (INCONEL X750)</b>				
X	□C	EXTRA COURSE			FINISH.	<b>REF TECHNICAL DETAIL</b>				
X.0	□C 0	COURSE			REF.	<b>EPG-10/18</b>				
X.00	□C 00	MEDIUM			PART NO.	<b>5C5N5N10P-TA1581U</b>				
X.000		FINE			NAME	DATE	SCALE NTS	COSCODE	DRAWING NO.	
		FINISH IN MICRONS			DRN	S.B			<b>TA1581U</b>	
~	> 25				CHD	K.G.P				
▽	8 -25				APPD					
▽▽	1.6 -8									
▽▽▽	0.025 -1.6									

04-12-2024 DATE APPROVED  
 ORIGINAL CHANGES MADE  
 REV NO 0