

RC CONNECTORS

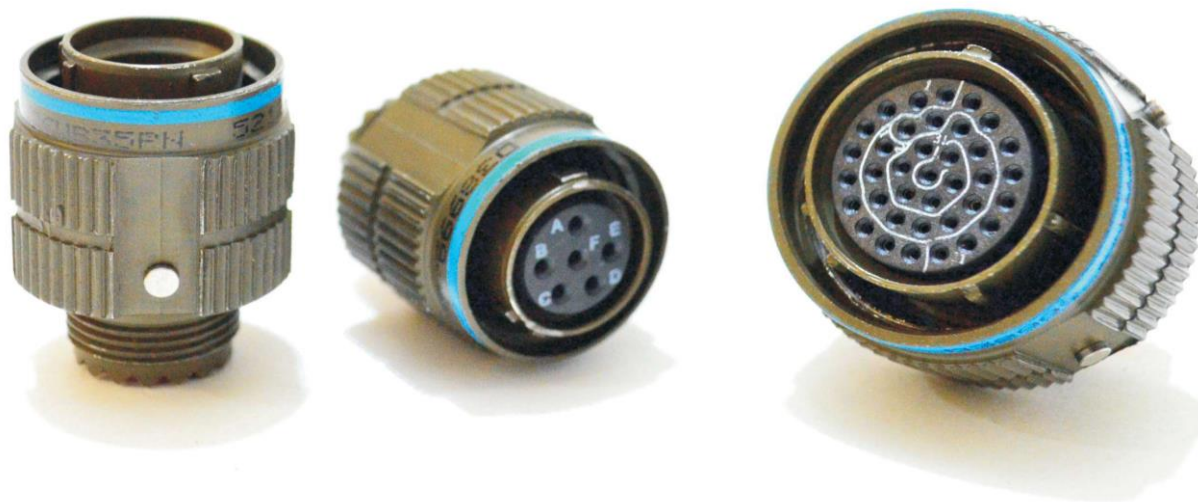
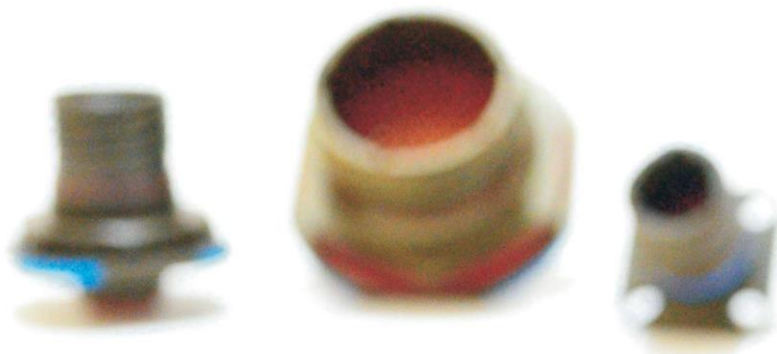

Цилиндрические соединители D38999

аналог серии СНЦ144

CONSTRUCTION Деталь	MATERIAL Материал детали	FINISH Материал покрытия
Shell Корпус	Aluminium Alloy Алюминиевый сплав	Cadmium Olive Drab over Electroless Nickle Electroless Nickle Оливково-серый кадмий или Никель
Insert Изолятор	Engineering Plastic Инженерный пластик	Natural
O-ring	Silicone Rubber	Natural
Contact Retainer	Beryllium Copper	Natural
Contact Контакт	Copper Alloy Латунь	1.27 μ Gold Plated Позолота 1.27 микродюйма
Retainer	Alloy Steel	Passivated
Grounding Ring	Beryllium Copper	Natural

SPECIFICATIONS

Характеристики

MECHANICAL

Endurance : 500 Cycles 500 циклов замыкания/размыкания

Size:	22D	20	16	12	8
Contact Retention Force (N)	44	67	111	111	111

Вибрационная перегрузка

Vibration : Sine: 60g, 140-2000 Hz at -65° to 200° C

Shock : 300g, 3ms

Wire Sealing Range :

Contact size	Minimum	Maximum
22D	0.76	1.37
20	1.02	2.11
16	1.65	2.77
12	2.46	3.61

ELECTRICAL

Test Voltate (Vrms) Mated

Напряжение пробоя

Service Rating	At Sea Level	At 70,000 Ft
M	1300	800
N	1000	600
I	1800	1000
II	2200	1000

Сопrotивление изоляции

Insulation Resistance : $\geq 5000 \text{ M}\Omega$ at 500vdc

Contact Size Типоразмер контакта	Current Rating (A) Рабочий ток
22D	5A
20	7.5A
16	13A
8	23A

Shell to Shell Conductivity :

Cadmium Olive Drab : 2.5m Ω

Nickle : 1m Ω

EMI Shielding Effectiveness : 100 MHz at 10 GHz attenuation 50db

CLIMATIC

Температурный диапазон

Working Temperature:

Class W: -65° to 200° C

Class F: -65° to 200° C

Стойкость к солевому туману

Resistance to Salt Spray:

Class W: 500 hrs at 35° C

Class F: 48 hrs at 35° C

Resistive to Fluid:

Gasoline

Connectors are fluid resistant to many fuels, solvents, coolants and oils.

Конфигурация артикулов разъемов

CONFIGURATION

D38999 / XX X X XX X X

Серия

Shell Style

Вариант конструкции

20 - wall mount receptacle

24 - jam nut receptacle

26 - straight plug

Shell Size

Условный размер корпуса

A, B, C, D, E,

F, G, H, I

Orientation

Схема расположения поляризаторов

Normal orientation

no marking,

for N, A, B, C, D, E,

Alternative position

Refer page - 5

Insert Arrangement

Номер схемы расположения контактов

Ref P - 4

Class

Материал покрытия корпуса

W- Cadmium Olive Drab

F - Electroless Nickle

For other plating finish
contact factory

Contact

Тип контакта

P- Pin contact Crimp type

S- Socket contact Crimp type

A- Pin style less pin contact

B- Socket style less socket contact

WALL MOUNTING RECEPTACLE

Вариант конструкции (приборный разъем с квадратным фланцем)

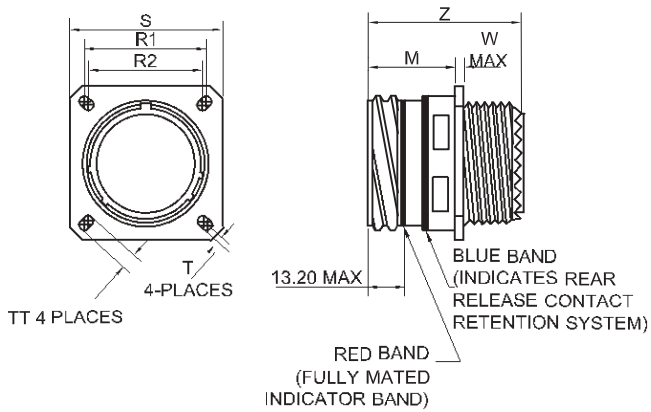

SHELL SIZE	SHELL SIZE CODE	M ±0.00 -0.13	R1	R2	S ±0.30	T ±0.1 -0.05	TT ±0.1 -0.05	W MAX	Z ±0.13 -0.25
9	A	20.83	18.26	15.09	23.83	3.25	5.49	2.5	31.36
11	B	20.83	20.06	18.26	26.19	3.25	4.93	2.5	31.36
13	C	20.83	23.01	20.62	28.58	3.25	4.93	2.5	31.36
15	D	20.83	24.61	23.01	30.96	3.25	4.93	2.5	31.36
17	E	20.83	26.97	24.61	33.32	3.25	4.93	2.5	31.36
19	F	20.83	29.36	26.97	36.53	3.25	4.93	2.5	31.36
21	G	20.07	31.75	29.36	39.67	3.25	4.93	3.2	31.36
23	H	20.07	34.92	31.75	42.88	3.91	6.15	3.2	31.36
25	J	20.07	38.1	34.92	46.07	3.91	6.15	3.2	31.36

Вариант конструкции (приборный разъем с креплением гайкой)

JAMNUT RECEPTACLE

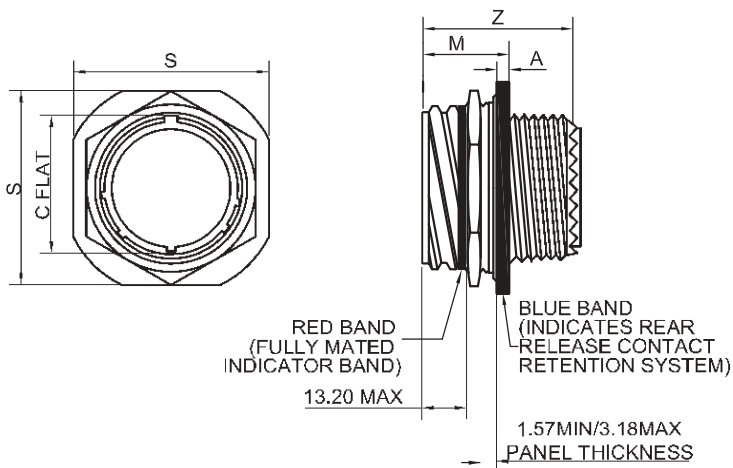

SHELL SIZE	SHELL SIZE CODE	A ±0.25 -0.13	C ±0.10 -0.25	Z ±0.13 -0.1	M ±0.13 -0.1	S MAX -0.05
9	A	2.64	16.53	31.57	22.12	26.97
11	B	2.64	19.07	31.57	22.12	31.75
13	C	2.64	23.82	31.57	22.30	34.92
15	D	2.64	26.97	31.57	22.30	38.10
17	E	2.64	30.15	31.57	22.30	41.28
19	F	3.43	33.32	31.57	22.30	46.02
21	G	3.43	36.5	31.57	22.30	49.23
23	H	3.43	39.67	31.57	22.30	52.37
25	J	3.43	42.85	31.57	22.30	55.38

Вариант конструкции (кабельный разъем)

STRAIGHT PLUG

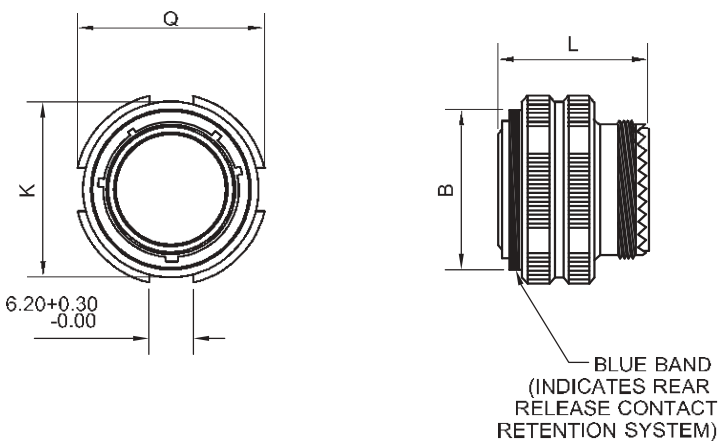

SHELL SIZE	SHELL SIZE CODE	B ±0.2 -0.13	K MAX	L MAX	Q DIA MAX
9	A	18.40	19.00	31.34	21.82
11	B	21.10	21.90	31.34	24.62
13	C	25.40	26.10	31.34	28.98
15	D	28.70	29.30	31.34	32.10
17	E	32.20	32.80	31.34	35.53
19	F	34.90	35.50	31.34	38.10
21	G	38.10	38.70	31.34	41.28
23	H	41.40	41.70	31.34	44.45
25	J	44.30	44.90	31.34	47.62

Размеры указаны в мм

CONTACT LAYOUT

Схема расположения контактов

VIEWED FROM THE FRONT FACE OF INSULATOR (вид со стороны монтажной части розеток)

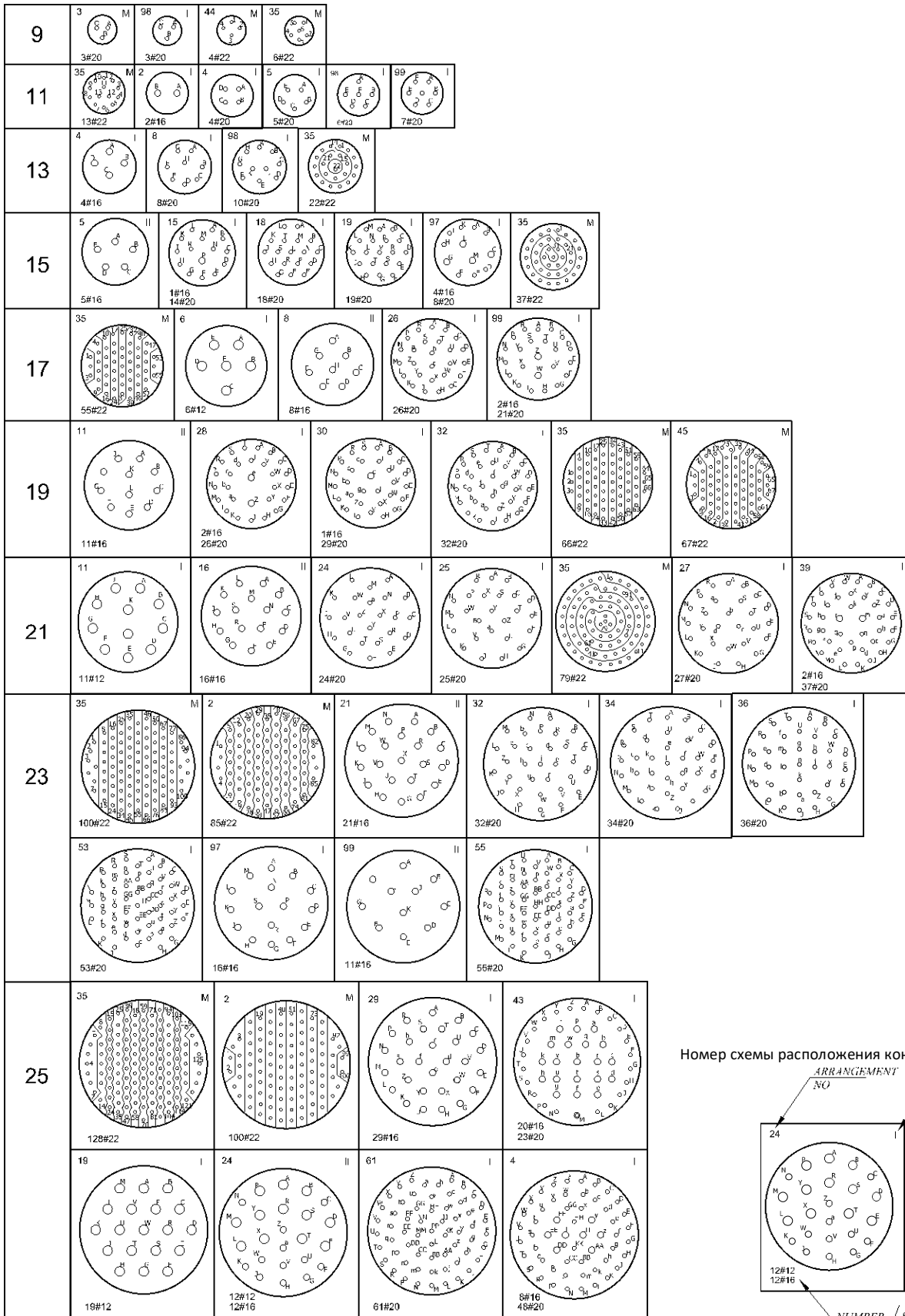

Номер схемы расположения контактов

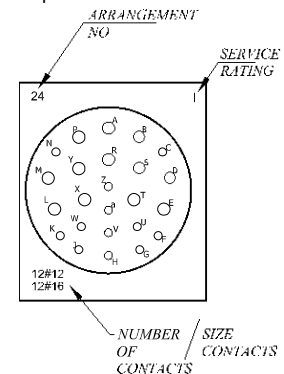

Количество контактов # Типоразмер контактов

PANEL CUTOUTS

WALL MOUNTING RECEPTACLE

Приборный разъем с квадратным фланцем

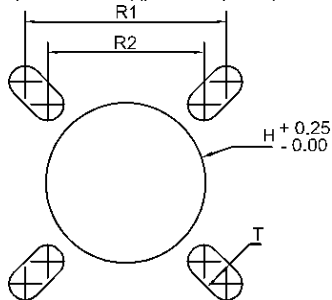

Размеры указаны в мм

Установочные размеры JAM NUT RECEPTACLE

Приборный разъем с креплением гайкой

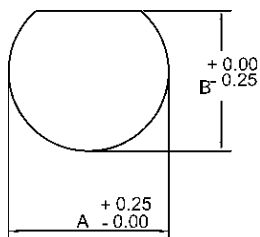

SHELL SIZE	A	B	H	R1 TP	R2 TP	T
9	17.78	17.02	15.90	18.26	15.09	3.40
11	20.96	19.58	19.08	20.62	18.26	3.40
13	25.65	24.26	22.25	23.01	20.62	3.40
15	28.83	27.56	25.43	24.61	23.01	3.40
17	32.00	30.73	30.18	26.97	24.61	3.40
19	35.18	33.91	31.78	29.36	26.97	3.40
21	38.45	37.08	34.95	31.75	29.36	3.40
23	41.53	40.26	38.38	34.92	31.75	4.06
25	44.70	43.43	41.30	38.10	34.92	4.06

ORIENTATION

Схема расположения поляризаторов VIEWED FROM THE FACE OF RECEPTACLE

Вид с торца приборного разъема

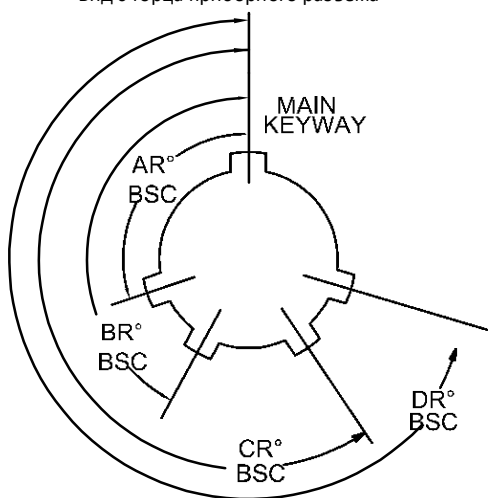

VIEWED FROM THE FACE OF PLUG

Вид с торца кабельного разъема

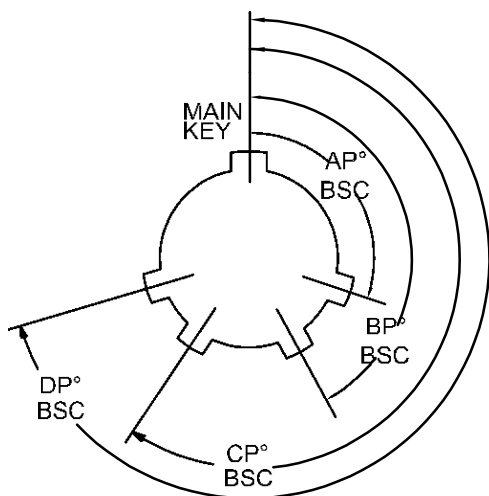

SHELL SIZE	Key & Keyway Arrangement Identification Letter	KEY LOCATION				
		AR° or AR° BSC	BR° or BR° BSC	CR° or CR° BSC	DP° or DP° BSC	
9	N	105	140	215	265	
	A	102	132	248	320	
	B	80	118	230	312	
	C	35	140	205	275	
	D	64	155	234	304	
11	N	95	141	208	236	
	A	113	156	182	292	
	13 &	B	90	145	195	252
		C	53	156	220	255
	15	D	119	146	176	298
E		51	141	184	242	
17 &		N	80	142	196	293
	A	135	170	200	310	
	B	49	169	200	244	
	19	C	66	140	200	257
		D	62	145	180	280
21	E	79	153	197	272	
	N	80	142	196	293	
	A	135	170	200	310	
	23 &	B	49	169	200	244
		C	66	140	200	257
25	D	62	145	180	280	
	E	79	153	197	272	

NOTE : 1) The position of the insert is rotated clock wise from the normal position (N) to the required angle "W" or "X" or "Y" or "Z".
2) The different orientation is used when more than one connector with same contact layout is used. It avoids coupling of the connectors with its neighbour.

Accessories: Protective Metallic Dust Cover

Заглушки (защитные крышки)

SPECIFICATION

MATERIAL :

- Cover : Class "F", "W" Impact extruded or machined Aluminium Alloy (материал крышки: алюминиевый сплав)
- Gasket : Silicon elastomer
- Ring : Corrosion resistance Steel, Passivated
- Rope : Stainless Steel Rope
- Fastener : Stainless steel Passivated

Mating Connectors : MIL - DTL - 38999, Series III

Ordering information for Protective Metallic Dust Cover Assembly

D38999 / XX X XX X

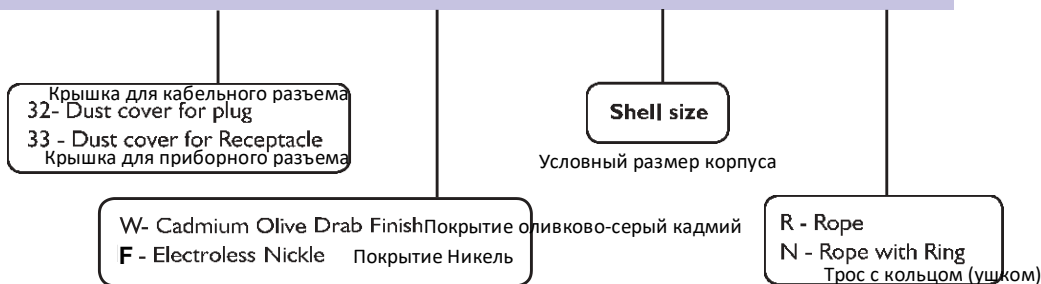

DUST COVER FOR RECEPTACLE

Крышка для приборного разъема

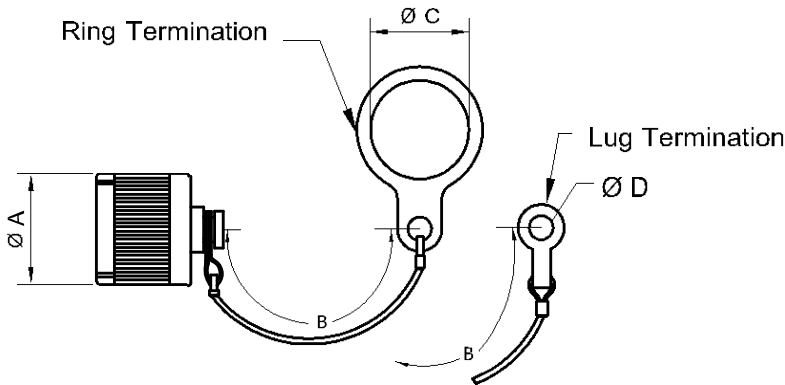

DUST COVER FOR PLUG

Крышка для кабельного разъема

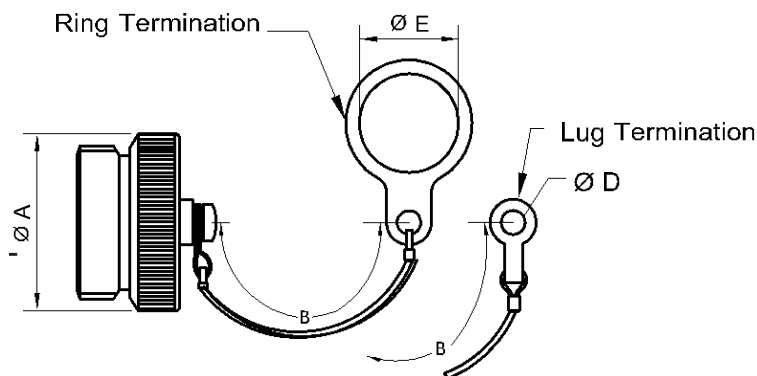

SHELL SIZE	ϕA MAX	$\phi A'$ MAX	B +13.0 -7.00	C MIN	ϕE MIN	D +0.25 -0.13
9	23.00	23.00	127.00	17.4	13.00	4.24
11	26.00	28.00	127.00	21.97	18.00	4.24
13	31.00	31.00	127.00	25.12	20.00	4.24
15	32.00	32.00	127.00	29.92	23.00	4.24
17	37.00	37.00	127.00	32.00	26.00	4.24
19	40.00	39.00	127.00	36.27	29.00	4.24
21	44.00	42.00	127.00	38.25	32.00	4.24
23	46.00	45.00	127.00	42.62	34.00	4.24
25	50.00	49.00	127.00	44.45	39.00	4.24

NOTE : Dust Cover is also available with Stainless Steel Chain Links of Bead Chain

CONTACTS

Contacts			Filler Plugs		Insertion & Extraction Tool		
Contacts size	Contact Type	Part Number	Specs	Color	Mil Spec	Insert Color	Extract
22d	Male	M39029/58-360	MS 27488-22-2	Black	M81969/14-01	Green	White
	Female	M39029/56-348					
20	Male	M39029/58-363	MS 27488-20-2	Red	M81969/14-02	Red	White
	Female	M39029/56-351					
16	Male	M39029/58-364	MS 27488-16-2	Blue	M81969/14-03	Blue	White
	Female	M39029/56-352					
12	Male	M39029/58-365	MS 27488-12-2	Yellow	M81969/14-04	Yellow	White
	Female	M39029/56-353					

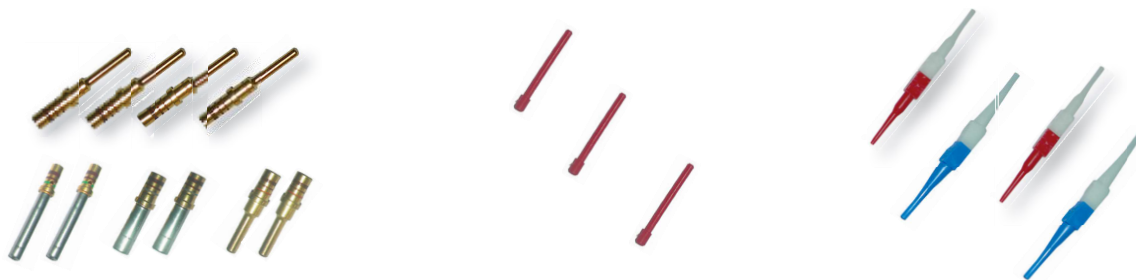

BACK SHELL

Back shells - Equivalent to M85049 for use with MIL-DTL - 38999 Series III Connectors.

The Back shell Ranges from Straight Cable Clamp, Heat Shrink Adaptor, Banding adaptor for Shield Termination and many more.

The back shell can also be developed for customized application.

NOTE : MIL-DTL-26482 Series II, MIL-DTL-38999 II and III Back Shells are available.

Ordering information for Back Shell

Конфигурация артикулов кожухов

M85049 / XX - XX X

14 - Back nut
38 - Straight Strain relief clamp
69 - Heat Shrink boot adaptor
88 - Banding adaptor straight
89 - Banding adaptor 45°
90 - Banding adaptor 91°

Shell size

Finish
W- Cadmium Olive Drab Finish
N - Electroless Nickel

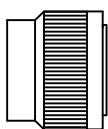

[14]

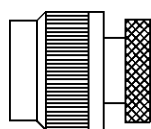

[69]

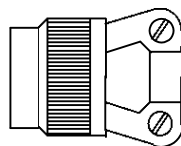

[38]

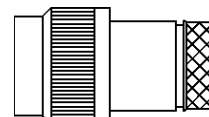

[88]

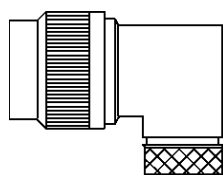

[90]

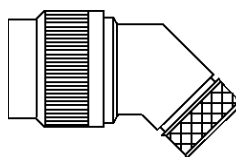

[89]

NOTE : Banding adaptor is available with different cable entry sizes, for more information contact factory



MIL - DTL-26482 SI



MIL - DTL-26482 SII



MIL - DTL-38999 SIII



BACK SHELLS

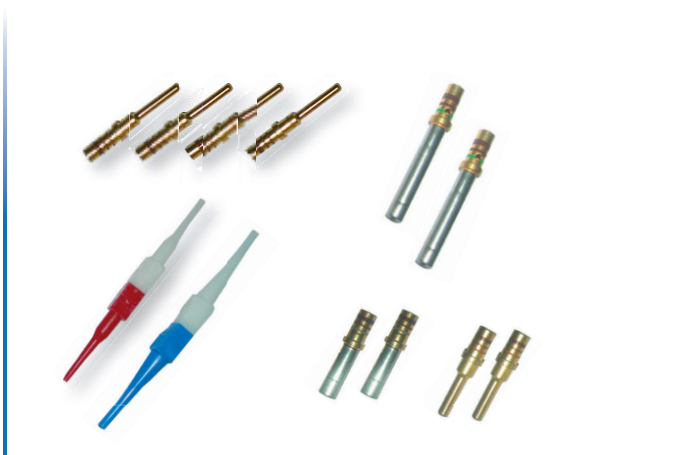

**CONTACTS &
INSERTS**

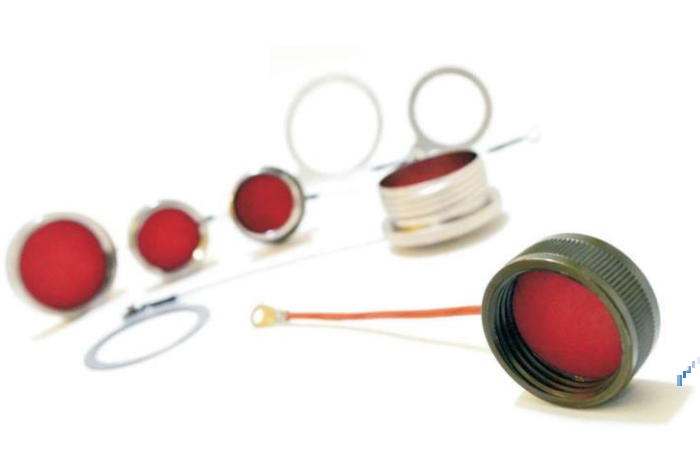

METALIC DUSTCAPS

RC CONNECTORS PRIVATE LIMITED

ООО "Теллур Электроникс"
117342, г.Москва, ул.Бутлерова, д.17
Тел.: +7 (495) 120-50-91
tellur-el.ru